

MINI STEEL WC CABINS

1200 x 1400mm Single Mains Toilet

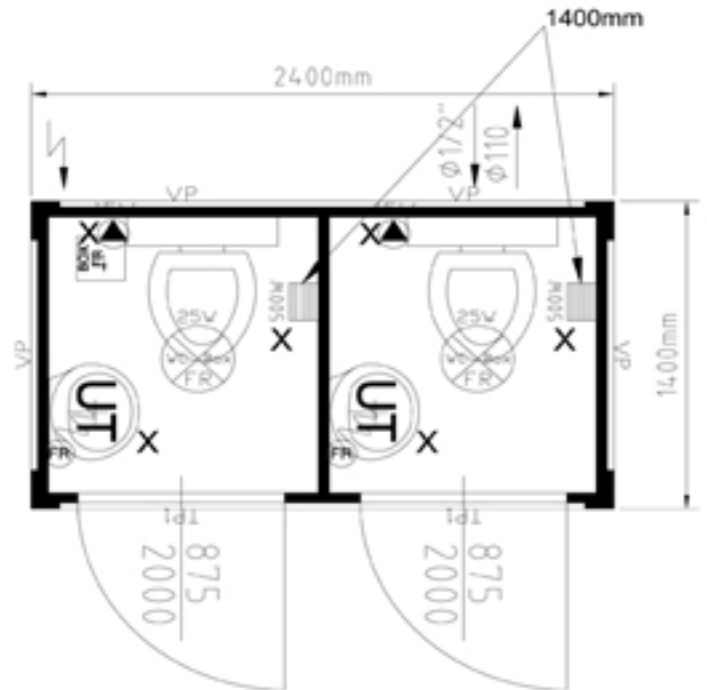

2400 x 1400mm Double Mains Toilet



Cabins and Containers

New, Used and Refurbished Portable Cabins, Modular Buildings and Containers

08454 98 91 98

sales@cabinsandcontainers.co.uk
www.cabinsandcontainers.co.uk

MINI STEEL WC CABINS

2400 x 1400mm Single Mains Shower

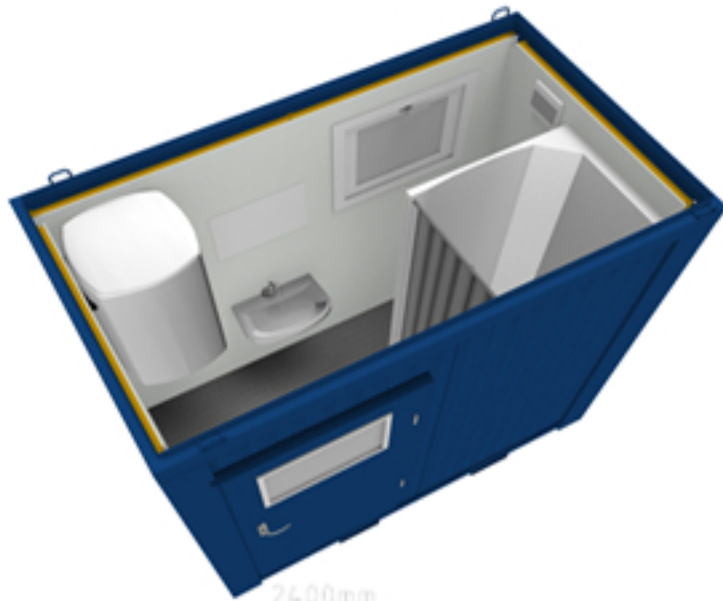

2400 x 1400mm Single Mains Toilet/Shower

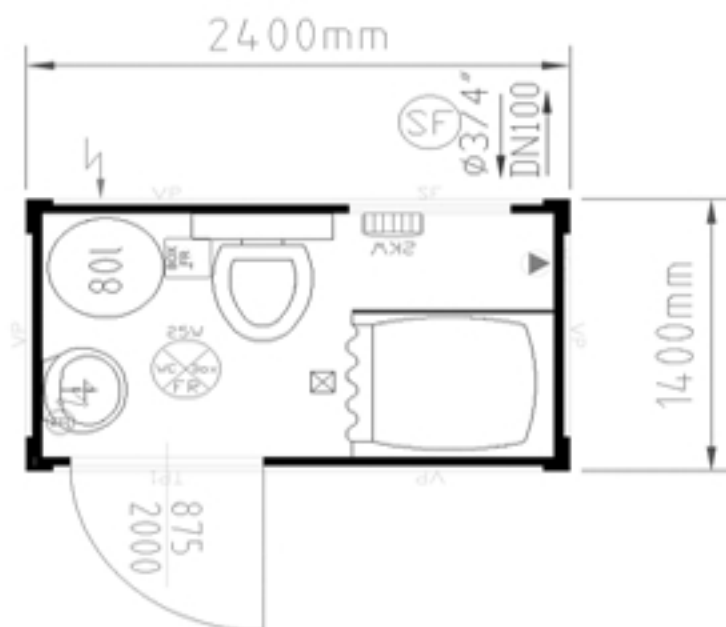

Technical Specifications

Dimensions (mm) and weights (kg):

	external			internal			
	length	width	height	length	width	height	weight
WC 5'	1,200	1,400	2,540	1,055	1,255	2,200	350
WC 8'	2,400	1,400	2,540	2,255	1,255	2,200	570

FLOOR:

- cold rolled frame, welded steel profiles, 2mm thick
- 4 welded container feet, fork pockets
- steel cross members with omega profiles = 2.5mm
- insulation: 60 mm mineral wool slabs (density 16 - 24 kg/m³)
- subfloor: 0.63mm thick, galvanised steel sheets
- internal floor: 3mm alu checker plate screwed to 22mm chipboard

ROOF:

- cold rolled frame, welded steel profiles, 2mm thick
- wooden cross members l x w = 80 x 40mm
- 2 or 4 lifting eyes
- roof cover: 0.63mm thick, galvanised steel sheet (riveted)
- insulation: 160mm mineral wool slabs (density 16 - 24 kg/m³)
- ceiling: 10 mm chipboard (V 20), laminated on both sides, white

WALL PANELS:

- PU panels; 45mm polyurethane (PU), (density 35 - 40 kg/m³)
- external cladding: corrugated, galvanised and coated steel sheet 0.6mm thick, blue RAL5010
- internal cladding: galvanised steel 0.5mm, white RAL9010

DOORS:

- right hand hinged, 875 x 2,000mm (811 x 1,968mm)
- steel door & frame, galvanised on both sides with 40mm insulation and integrated wire glazing 500 x 450mm
- cylinder lock: lockable from inside by turning handle

ELECTRICAL:

- 230V distribution board, light, wall heaters, water heaters and shower boilers; depending on unit type

PLUMBING:

- water supply: 1/2" pipe through the cabin wall at the rear side
- waste water: collected in 50mm & 110mm waste pipes

INSULATION:

- floor: thickness = 60 mm U= 0.54 W/m² K
- roof: thickness = 160 mm U= 0.25 W/m² K
- external wall: thickness = 45 mm polyurethane U= 0.489 W/m² K

PAINT:

- paint system with high weather and ageing resistance, suitable for urban and industrial atmospheres
- wall panels: 25 µm paint thickness
- frame: 20-40 µm primer, 40-50 µm topcoat



Cabins and Containers

New, Used and Refurbished Portable Cabins, Modular Buildings and Containers

08454 98 91 98

sales@cabinsandcontainers.co.uk
www.cabinsandcontainers.co.uk